

"DIN 934"

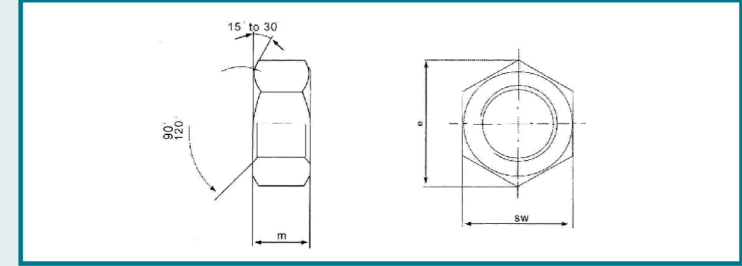

HEXAGON NUT
ALTİKÖŞE SOMUN
SECHSKANTMUTTERN



Technical informations. / Teknik bilgiler.

| Thread size / Anma çapı | | M3 | M4 | M5 | M6 | M7 | M8 | M10 | M12 | M14 | M16 | M18 | M20 | M22 | M24 | M27 |
|-------------------------|-------|------|------|------|-------|-------|-------|-------|-------|-------|-------|-------|-------|-------|-------|-------|
| Pitch / Diş adımı | P | 0.50 | 0.70 | 0.80 | 1.00 | 1.00 | 1.25 | 1.50 | 1.75 | 2.00 | 2.00 | 2.50 | 2.50 | 2.50 | 3.00 | 3.00 |
| Head width/Anahtar a. | SW | 5.5 | 7 | 8 | 10 | 11 | 13 | 17 | 19 | 22 | 24 | 27 | 30 | 32 | 36 | 41 |
| Diagonal/Köşegen | e | 6.01 | 7.74 | 8.87 | 11.05 | 12.12 | 14.38 | 18.90 | 21.10 | 24.49 | 26.75 | 30.14 | 33.53 | 35.72 | 39.98 | 45.69 |
| Height/Yükseklik | m | 2.4 | 3.2 | 4 | 5 | 5.5 | 6.5 | 8 | 10 | 11 | 13 | 15 | 16 | 18 | 19 | 22 |
| | min. | 2.10 | 2.90 | 3.70 | 4.70 | 5.20 | 6.14 | 7.64 | 9.64 | 10.30 | 12.30 | 14.30 | 14.90 | 16.90 | 17.90 | 20.50 |
| Weight/Ağırlık | gr/p. | 0.38 | 0.81 | 1.23 | 2.50 | 3.12 | 5.20 | 11.6 | 17.3 | 25.0 | 33.3 | 49.4 | 64.4 | 79.0 | 110 | 165 |

| Thread size / Anma çapı | | M30 | M33 | M36 | M39 | M42 | M45 | M48 | M52 | M56 | M60 | M64 | M68 | M72 | M76 | M80 |
|-------------------------|-------|-------|-------|-------|-------|-------|-------|-------|-------|-------|-------|--------|--------|--------|--------|--------|
| Pitch / Diş adımı | P | 3.50 | 3.50 | 4.00 | 4.00 | 4.50 | 4.50 | 5.00 | 5.00 | 5.50 | 5.50 | 6.00 | 6.00 | - | - | - |
| Head width/Anahtar a. | SW | 46 | 50 | 55 | 60 | 65 | 70 | 75 | 80 | 85 | 90 | 95 | 100 | 105 | 110 | 115 |
| Diagonal/Köşegen | e | 51.29 | 55.80 | 61.31 | 66.96 | 72.61 | 78.26 | 83.91 | 89.56 | 95.07 | 99.21 | 104.86 | 110.51 | 116.16 | 121.81 | 127.46 |
| Height/Yükseklik | m | 24 | 26 | 29 | 31 | 34 | 36 | 38 | 42 | 45 | 48 | 51 | 54 | 58 | 61 | 64 |
| | min. | 22.50 | 24.00 | 27.00 | 28.50 | 32.40 | 34.40 | 36.40 | 40.40 | 43.40 | 46.40 | 49.10 | 52.10 | 56.10 | 59.10 | 62.10 |
| Weight/Ağırlık | gr/p. | 223 | 288 | 393 | 502 | 652 | 800 | 977 | 1220 | 1420 | 1690 | 1980 | 2300 | 2670 | 3040 | 3440 |

Values are given in millimeters. / Değerler milimetre olarak verilmiştir.