

# "DIN 934/ F"

HEXAGON NUT (FINE THREADED)

ALTIKÖŞE SOMUN

SECHSKANTMUTTERN (FEINGEWINDE)

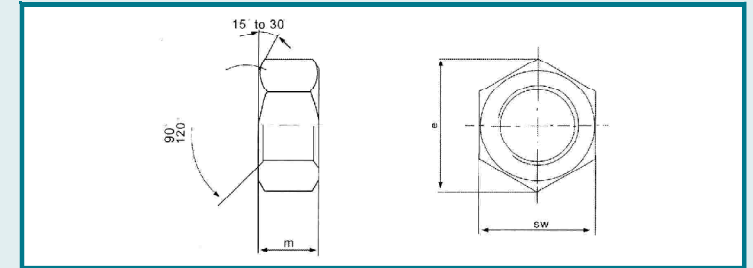

Technical informations. / Teknik bilgiler.

Thread size / Anma çapı		M8	M10	M12	M14	M16	M18	M20	M22	M24	M27	M30	M33	M36	M39
Pitch / Diş adımı	P <sub>1</sub>	1.00	1.25	1.50	1.50	1.50	2.00	2.00	2.00	2.00	2.00	2.00	2.00	3.00	3.00
	P <sub>2</sub>		1.00	1.25			1.50	1.50	1.50	1.50	1.50	1.50	1.50	1.50	1.50
Head width/Anahtar a.	SW	13	17	19	22	24	27	30	32	36	41	46	50	60	60
Diagonal/Köşegen	e	14.38	18.90	21.10	24.49	26.75	30.14	33.53	35.72	39.98	45.63	51.28	55.80	61.31	66.46
Height/Yükseklik	m	6.5	8	10	11	13	15	16	18	19	22	24	26	29	31
Weight/Ağırlık	gr/p.	5.20	11.6	17.3	25.0	33.3	49.4	64.4	79.0	110	165	223	288	393	502

Values are given in millimeters. / Değerler milimetre olarak verilmiştir.